

The image shows a close-up of a ceramic artwork. It features a dark, textured grid-like structure made of intersecting rectangular bars, resting on a light-colored, horizontally ribbed ceramic surface. The background is a plain, light-colored floor.

ORNAMENTAL PLAY

THE MEETING AS CERAMIC SKETCH, CERAMIC SPACES

GALLERY OXHOLM 6. DECEMBER 2013 – 3. JANUAR 2014

ANJA MARGRETHE BACHE

*Layout and text Anja M. Bache
Translation of text Morten Stinus*

*The installation is made of
Specific Ceramic Glazed Concrete, 40 - 130 cm x 1-2 cm and painted wood
40-130 cm x 1 cm
The Ceramicpanels are created at the Danish Artworkshop, Gammel DOK,
2013*

*Figures:
Ceramic Installation and sketches of Anja Margrethe Bache seeking dia-
logue with triangular pots of ceramic artist Ane-Katrine von Bülow and the
gallery space.
Photos Ole Akhøj*

.

ORNAMENTAL PLAY

THE MEETING AS CERAMIC SKETCH, CERAMIC SPACES

GALLERY OXHOLM 6. DECEMBER 2013 - 3. JANUARY 2014

ANJA MARGRETHE BACHE

ORNAMENTAL PLAY

The meeting as ceramic sketch, ceramic spaces

In the years 2009-2013, I developed specific ceramic glazed concrete in a project sponsored by The Realdania Foundation and in my role as associate professor at DTU BYG, the section of Architectural Engineering. I did this by synthesizing material and process technology as well as art, design, and architecture and also by combining technical research and artistic research with practice. In this project as well as in my interdisciplinary work in general, I develop art that interrogates the world that surrounds it, hereby acquiring factual and explicit knowledge, including the tacit knowledge we acquire by acting, and experiencing through both our senses and emotions.

The exhibition at Gallery Oxholm consists of a meeting between my works of specific ceramic glazed concrete that arise from architecture and approaches installation art, as well as the craft works of ceramic artist Ane-Katrine von Bülow. Here, I display ceramics based on concrete created at the Danish Art Workshops during 2013 as well as pegs painted grey that form a ceramic sketch, which overtly and curiously, but also being integrated into the ornamental structures, interrogates the ceramic spaces when encountering Gallery Oxholm and Ane-Katrine von Bülow triangular and decorated pots.

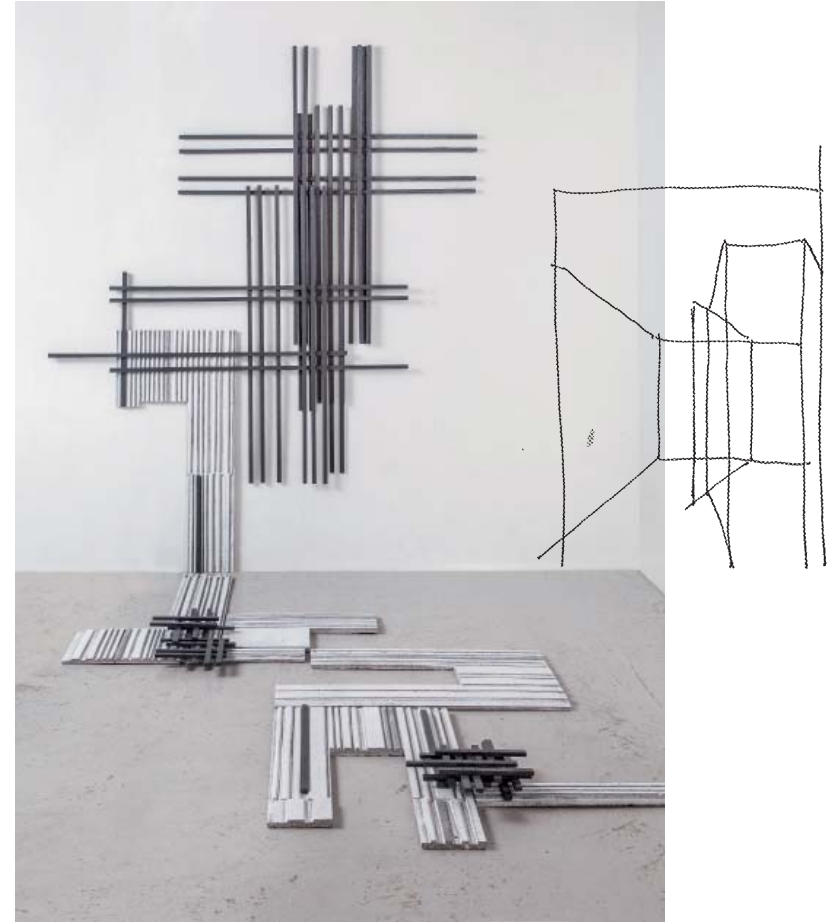

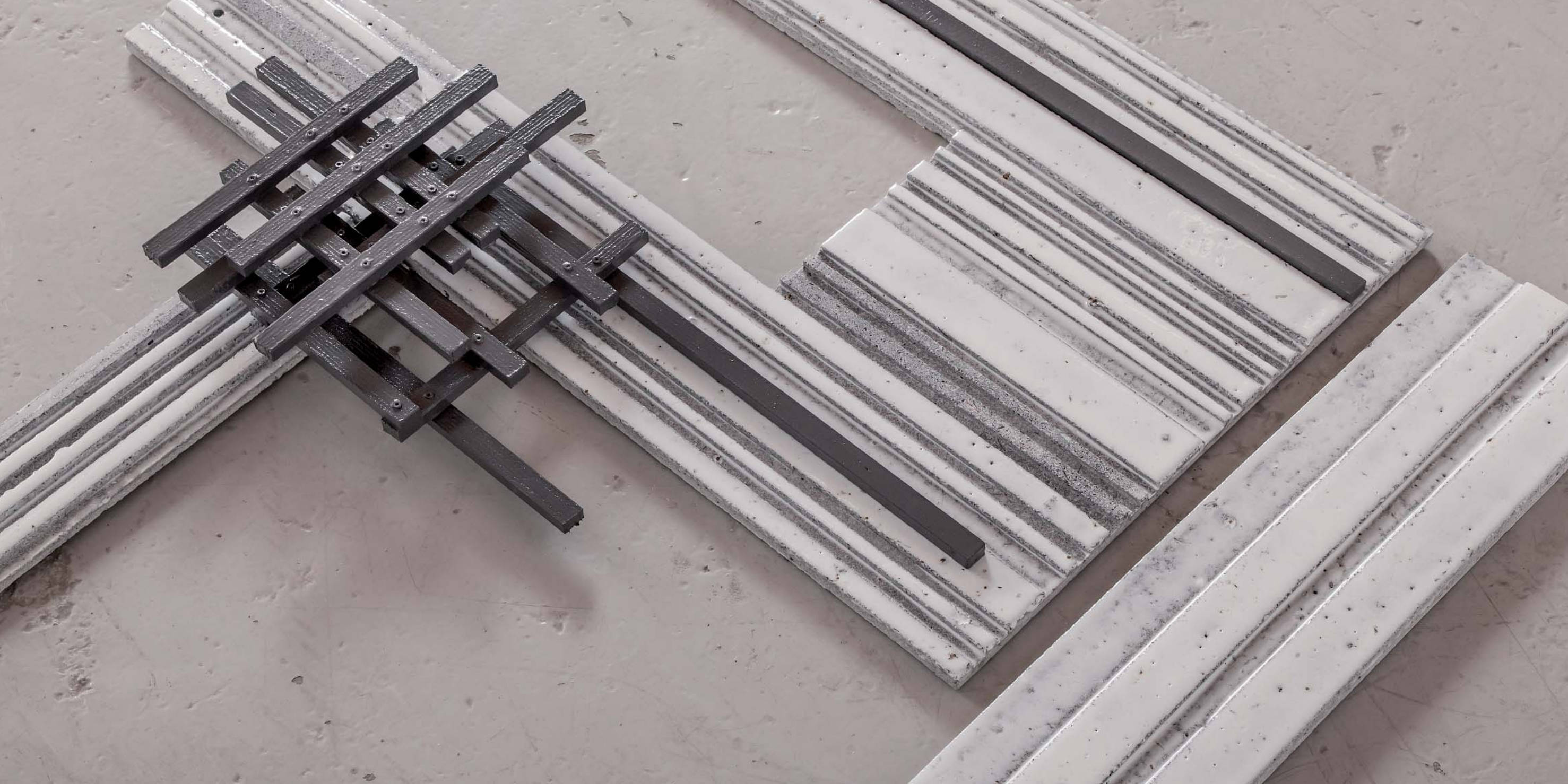

The starting point of the sketch is the pre-fabricated, industrial building that consists of building elements and construction systems characterized by installation and juxtaposition. As a decorative shell, the face of the building, millimetre-thin façade panels today obscure several functional layers of the outer walls of buildings. The ventilated, suspended façade is the presentation that occurs in new buildings and especially in renovated buildings that have to meet the energy efficiency demands of today. The contribution to the exhibition is like a sketching phase, moving away from operation of the factual façade towards the spatial play of the installation ceramic searching for the aesthetic, spatial, textual, and colour aspects. It is like an examination of patterns, structures, and the textile play with the diffusion of light.

Anja Margrethe Bache

Associate professor, DTU BYG, Architectural Engineering

Artist, The Royal Danish Academy of Fine Arts

PhD, Architecture

Master of Science Engineer

www.anjabache.com

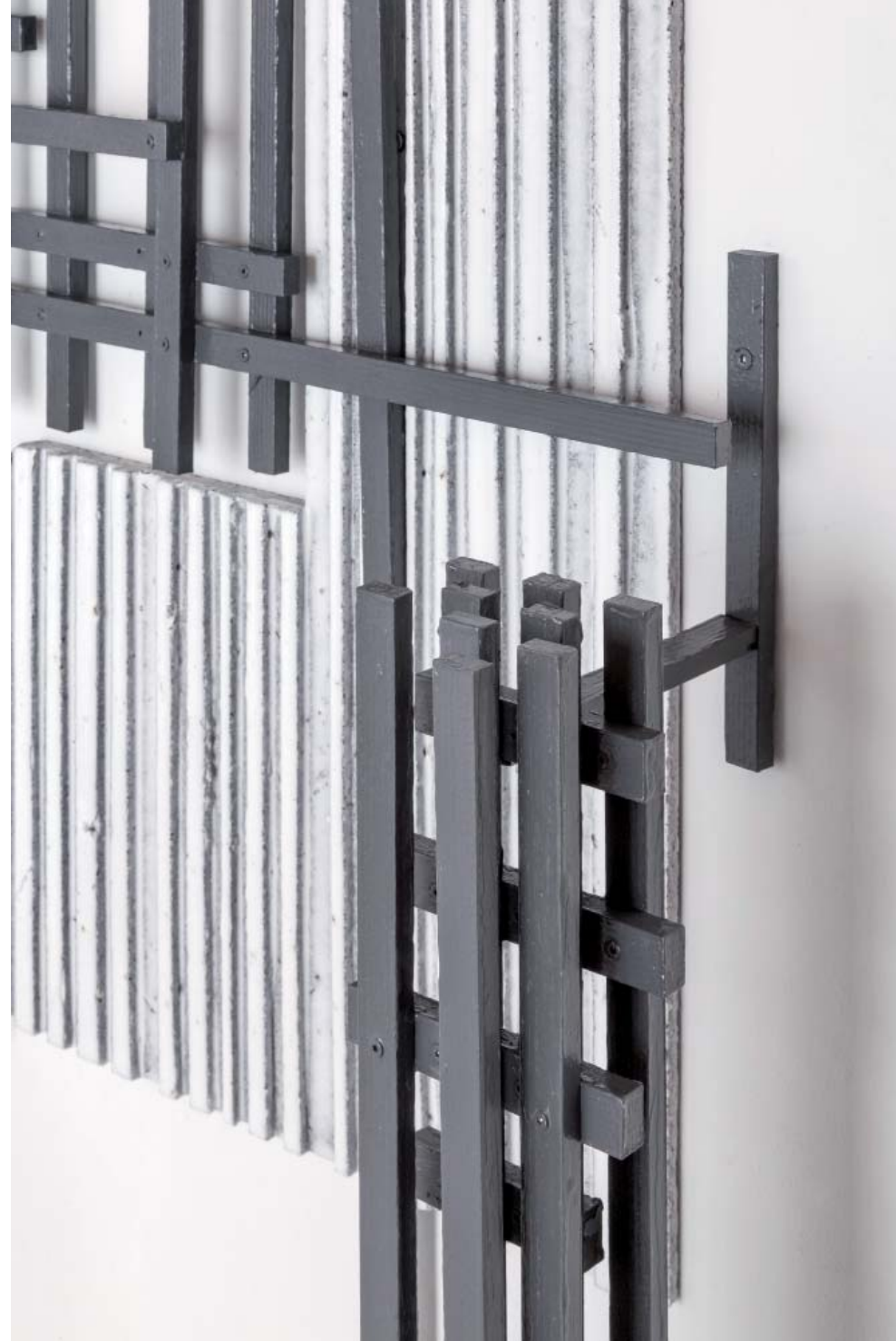

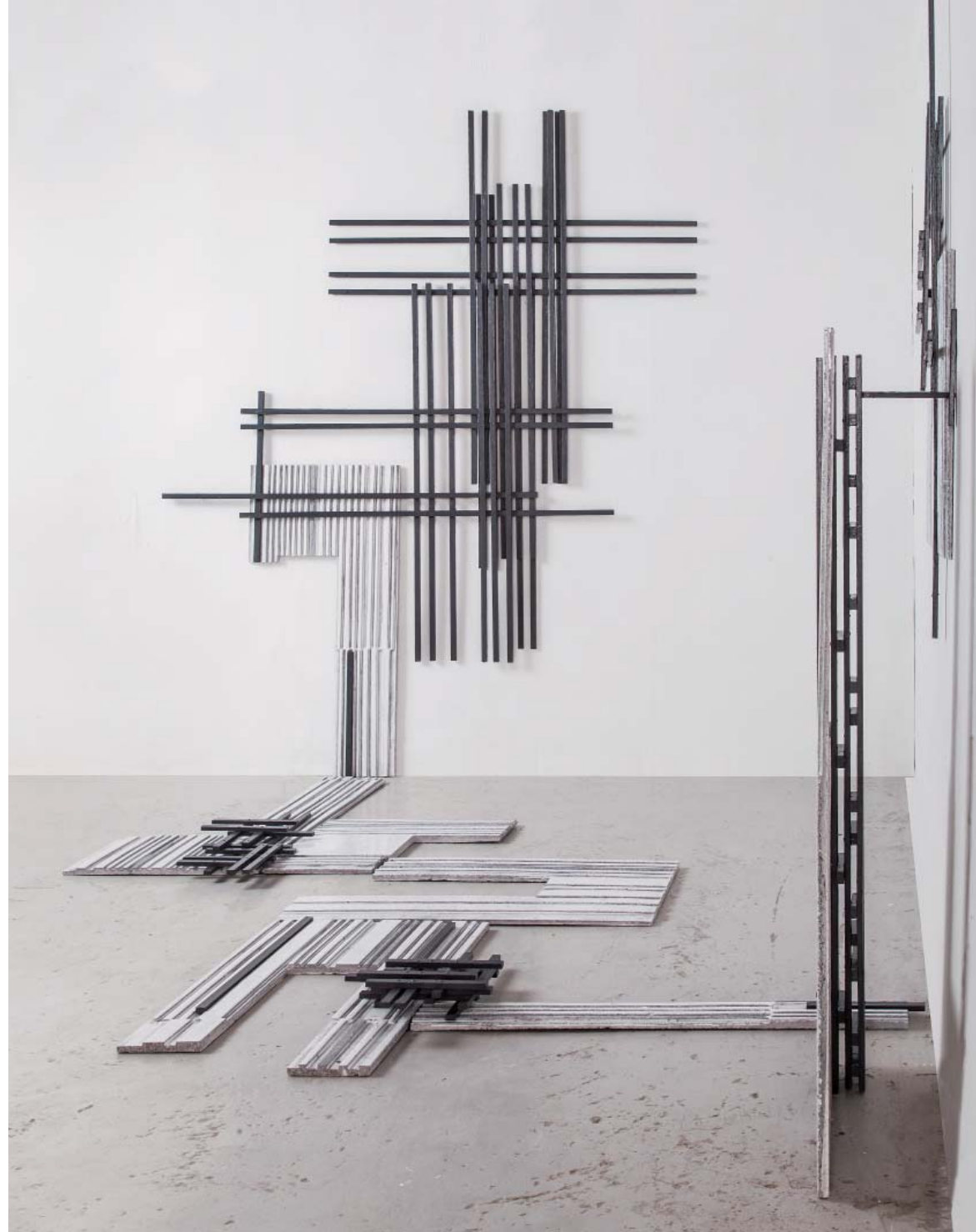
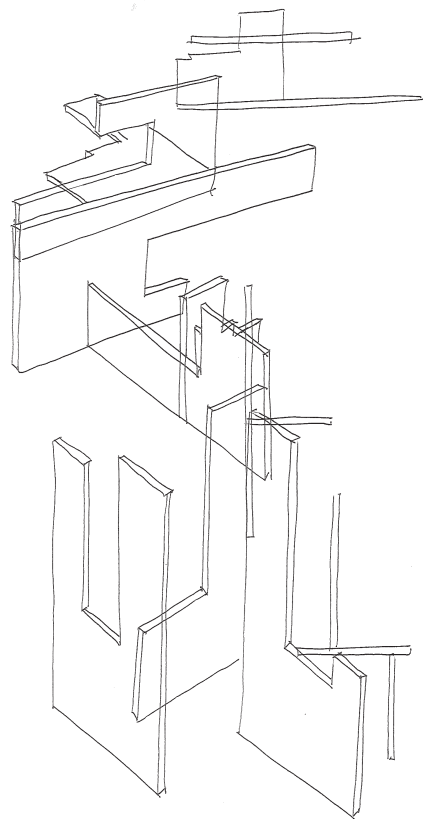
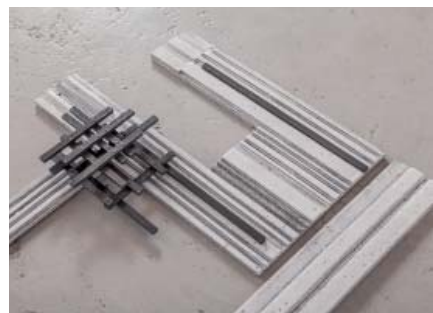

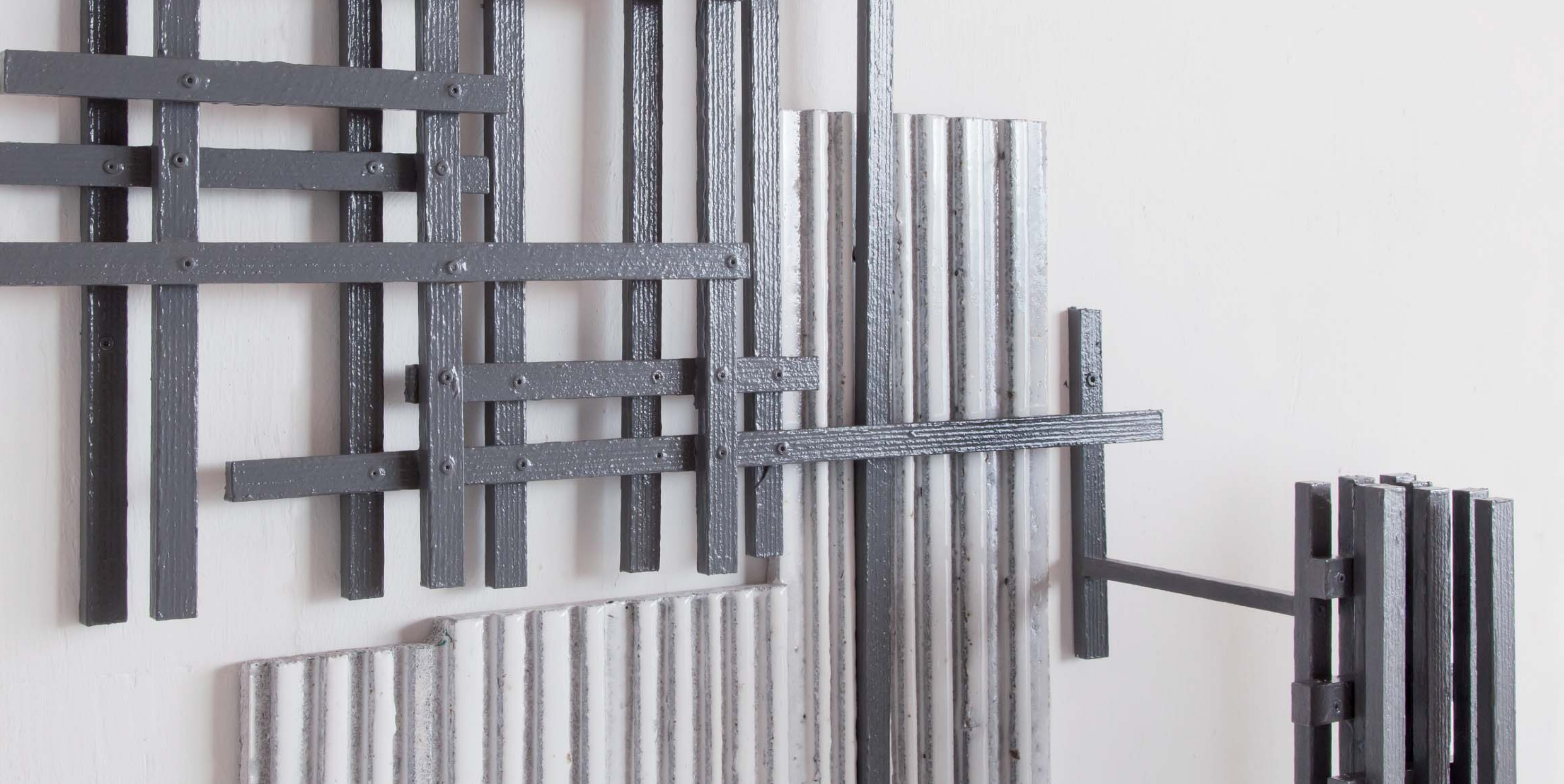

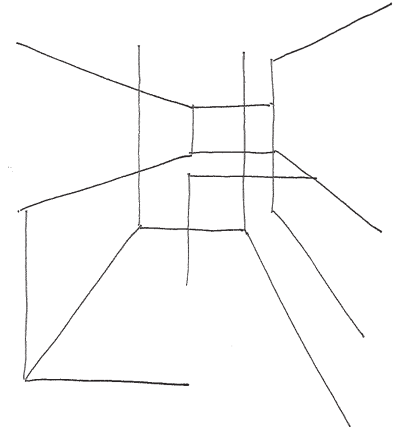

CURRICULUM VITAE

ANJA MARGRETHE BACHE

Associate Professor
Technical University of Denmark
Department of Civil Engineering, Architectural Engineering
Artist the Royal Academy of fine arts
Master of Science engineer
PhD architecture
a.m.bache@mail.dk
www.anjabache.com
0045 22511551

MY RESEARCH AND ART

My research and art is cross skilled. I combine, make synthesis between and transform knowledge across technology, art, design and architecture. I pose questions, and wish to understand, sense, experience and try to push the limits of each subjects. That is my playground for research and art.

EXHIBITIONS

2014 Birkerød Præstegård
2014 Officinet
2014 Grønbechsgård
2013 Charlottenborg Spring Exhibition, Censured
2013 Craft Beinnalen, Censured
2013 Galleri Oxholm
2013 Gallery Marsden Woo London
2013 Galleri 21 Mamø
2012 Museum of International Ceramic Art, Grimmerhus
2006 Dronninglund Arts Centre
2004 Charlottenborg Spring Exhibition, Censured
1998 Gallery Nord
1997 Gallery 2112
1995-98 Various art societies
1995 Den Frie Centre of Contemporary Art, fall exhibition, Censured

1993 Sophienholm
1987 Charlottenborg spring exhibition, Censured
1987 Den Frie Centre of Contemporary Art, fall exhibition, Censured

GRANTS AND FOUNDATIONS

2013 Fonden Realdania
2013 Svannekegården, Grants
2013 Danish Art Workshops, Grants
2012 Danish Art Workshops, Grants
2011 Grosserer L.F. Foght’s foundation
2011 The Danish Government Art Fund’s work grant, arts, crafts, and design
2011 The Danish Central Bank’s Anniversary Foundation of 1968
2011 San Cataldo, Italy, artists’ retreat, writing book
2010 The Danish Government Art Fund’s work grant, Architecture committee
2010-2011Guldagergaard, International Ceramics Research Center, artists’ retreat,
2009 Realdania Foundation
2007 Danish Art Workshops
2006 Danish Art Workshops
2006 Housing foundation, Kuben
2002 Realdania Foundation
2002 Knud Højgård’s Foundation
1994 Knud Højgård’s Foundation
1994 J. Lauritzen’s Foundation
1994 Beckett Foundation
1987 First prize, winner of decoration competition in cooperation with Hanne Ravn Hermansen

EDUCATION

2002 Completed PhD in Architecture, Aarhus School of Architecture, Center for Integrated Design. Compact Reinforced Composite, Survey of new composite technologies, ‘Architectural potentials, based on durability, comfort, and shape’
1997-98 PhD Researcher education, the Technical University of Denmark, transferred to research school at the School of Architecture to unite competences.
1996 Completed MFA at The Royal Danish Academy of Fine Arts, School of Fine Arts, graduated from MUR and RUM

1994	Completed Master of Science Engineering at the Technical University of Denmark, specializing in design and development of composite materials
1994	Studies of sculpture and painting, Santiago Chile, Universidad Metropolitana de la Ciencias de la Educacion
1987	Studies in Paris, graphics, polychrome aguatinte on one sheet at Joelle serve, Atelier 17, Paris, graphics with polychrome print1985-88Student of graphic design at The Danish School of Art and Design

EMPLOYMENT

2008-	Associate Professor, Building Design, the Technical University of Denmark
2007	External lecturer, Architectural Engineering, the Technical University of Denmark
2007	Designer, Gottlieb Paludan Arkitekter A/S
2007-08	Design teacher at Tec, part time teach, Gymnasium
2006-07	Foundation-supported developing project in own firm, artistic development project, ‘Urban Light’
2005-	Scientific editor, Arkitekten Magazine, Arkitektens Forlag
2004-05	Researcher at the Danish Building Research Institute, Building Technology and Design
2002-04	Foundation supported artistic development project, the Realdania Foundation and Knud Højgård’s Foundation, carried out at Aarhus School of Architecture.
2002	Course of lectures, University of Aalborg, Architecture and Design
1992	Project employee at Aalborg Portland A/S
1991	Project employee at Aalborg Portland A/S
1986	Employee at the Patent Agency Plougmann og Vingtofte A/S

Researcher at Zero Waste Byg research center. Initiator and in the steering group of Center of Sustainable Textiles in Buildings, a collaboration with the Royal Danish Academy of Fine Arts Designdepartment. Reviewer for numerous Journals within varying topics related to architecture. Key Note Speaker at international seminars amoingst others 150 years that built the future’ BYG-DTU and Creative Systems,’ The Royal Danish Academy of Fine Arts, School of Architecture.

SUPERVISION

PhD student, BSc and MSs Students from the Section of Architectural Engineering in their final projects, and Students at The Royal Academy of Fine Arts, School of Design in their final projects, and

first opponent at PhD defence at Oslo School of Architecture.

PUBLICATIONS

BOOKS

Bache, Anja Margrethe Bache, 2014, Design in a broad perspective, Specific ceramic glazed concrete, Polyteknisk Forlag. Kongens Lyngby, 250 pages, (coming book march 2014)

Bache, Anja Margrethe Bache, 2012, Ceramic Spaces, Displacements;Ceramic Glazed Concrete Catalogue, DTUBYG, ISBN nr. 9788778773357, Lyngby

Marsh. R. & Bache, A. (2005). Råhus + Teknik: Samspillet mellem bygninger og deres tekniske installationer, SBi,

Bache, A., (2004). Ny beton-Ny form, med støtte fra Arkitektskolen Aarhus,

ARTICLES

Bache, Anja Margrethe, (2012), Ceramic Glazed Concrete, New Ceramics 4/2012, The European Ceramic Magazine, Side, p. 21-23.,

Bache, A. (2010), Glazed Concrete, Development of Large Scale Ceramic glazed Concrete Sculptures in Public spaces, 2010, Ceramic Art and Perception Technical, No.31. New Richmond,Wisconsin USA.

Bache, A. (2010), Large Scale Glazed Concrete Panels a dialogue with Architecture, 2010, Conferencepapers, Colour and Light in Architecture, International Conference, Venice Italy, IUAV University of Venice Italy,

Bache, A. (2008), Technology transfer, Arkitekten, March, Arkitektens Forlag, Copenhagen.

Bache, A. (2007), Technology Transfer to Architectural and Design Praxis, article in book, ‘150 years build the future’, BYG-DTU, 2008

Bache, A. (2007), Urban Light, Det Multifunktionelle Lysmøbel i ny kompositteknologi til byrum, Arkitekten September, Arkitektens Forlag, København

Bache, A. (2006). Det præfabrikerede kompakte mikro-hjem, Arkitekten 1/06, Arkitektens Forlag, København.

Bache, A. (2005). Tyndplader Facadebeklædning, Arkitekten 13/05, Arkitektens Forlag, København, 6 pages.

Bache, A. (2003). En ny betonteknologis formverden, Arkitekten magasin 09 105. årgang, s. 19-21, København, Arkitektens Forlag, 3 pages.

Bache, Anja (2000). To Betonkirker, Arkitekten magasin 04 102. årgang, s.10-17, København, Arkitektens Forlag, 8 pages.

ARTICLES WRITTEN ABOUT MY WORK OTHER AUTHORS

Lorentzen, Helle, 2013, Betonkeramik facader, Design Magasinet Inform01/2013
Wirnfeldt, Pia, December 2012, Ceramic Glazed Concrete the work of Anja Bache as art, 6 sider, Magazine Ceramic Art and Perception Windum, Keld, Interview af Anja Bache, 2012, Anja Bache
Betonkeramik, Arkitektur, 3/12, s. 66-71, Arkitektens Forlag 2012
Borch Nielsen, Jan, 2011, Keramiske Overflader, s.30-31, Magasinet Beton, København

REVIEWS

Bache, A. (2006). Kunst og Kirke, Arkitekten 3/06, Arkitektens Forlag, København, 2 pages.
Bache, A. (2005). CUMULUS, designkonference, Arkitekten 13/05, Arkitektens Forlag, København, 2 pages.
Bache, A. (2005). Sted, Rum, Grænseflade, Arkitekten 13/05, Arkitektens Forlag, København,1 page.
Bache, A. (2006). BYG-ERFA buskonference, Arkitekten 2/06, Arkitektens Forlag, København,1 page.

SHORT ARTICLES

Arkitekten 12/05 og 14/05, examples.

DISSERTATIONS

Bache, A. (2002). Compact Reinforced Composite, undersøgelse af en ny betontechnologis Arkitektoniske potentialer vurderet i forhold til holdbarhed, komfort og form, Aarhus, Arkitektskolen i Aarhus. 262 pages main report and 262 pages appendix report.
Bache, A. (1994). CRC-metal, Lyngby, Danmarks Tekniske Universitet, Procesteknisk Universitet. 297 pages, of which 35 pages are appendix.
Bache, A., (1992). Undersøgelse af tilslag i frisk beton som funktion af binde middelsammensætning og fremstillingsproces, CBL Rapport No. 50, Aalborg, Aalborg Portland A/S. 65 pages.
Bache, A. & Henningsen, P. (1992). Kompositmaterialer, Lyngby, Danmarks Tekniske Universitet, Procesteknisk Universitet, 112 pages.
Bache, A. (1991). Dispergering og flydeopførsel af finpartikel væskesystemer med høj volumenkoncentration, Aalborg, Aalborg Portland A/S, 47 pages.